



TANDEM



FAQ

Quick facts:

- Available in 30kg with smooth running motion
- With soft-close BLUMOTION to close softly and effortlessly
- TANDEM offers minimal opening forces and a feather-light glide

- Country of origin: Austria
- Motion technologies: BLUMOTION and SERVO-DRIVE
- Material / Drawer runners in zinc plated steel

- Cabinet width: from 300mm to 1200mm

FAQ sections:

[Basic Product Information](#)

[Technical information](#)

[Trouble shooting](#)

What is TANDEM?

TANDEM is a concealed runner system and the versatile solution for your wooden drawers.

The extremely wide range of options offers great design flexibility. Choose from a broad selection of nominal lengths, various types of extension and load bearing classes as well as optional motion technologies for soft and effortless opening and closing.

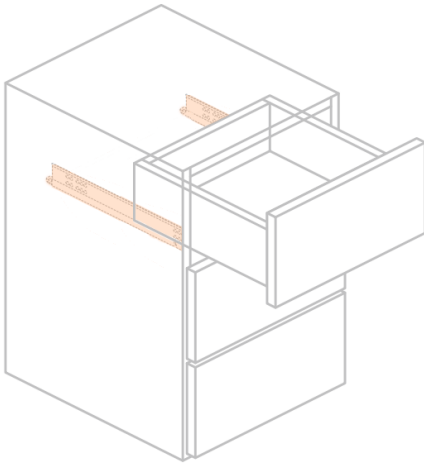

What material is TANDEM made of?

The drawer runners are made of **zinc plated steel**.





Basic product info

What is the **difference** between **single** and **full extension**?

Full extension refers to the ability of the drawer to open all the way to give full access to the drawer interior.

Single extension (aka. Part extension) does not come out of the cabinet all the way. A portion of the drawer interior is hidden in the cabinet, even if the drawer is fully opened.

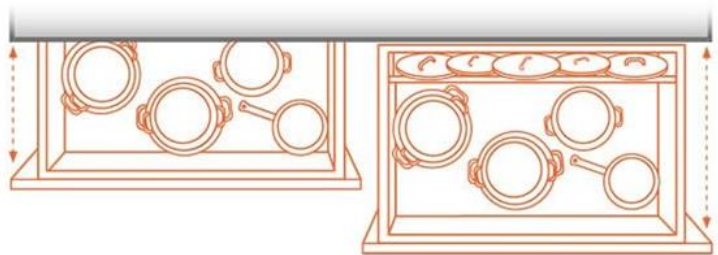

Single extension

Full extension

How can I **differentiate** between a **single** and **full extension** runner?

Full extension runners are thicker on top 30mm. Whereby the **single extension** is slimmer with 18mm. The image below illustrates this.

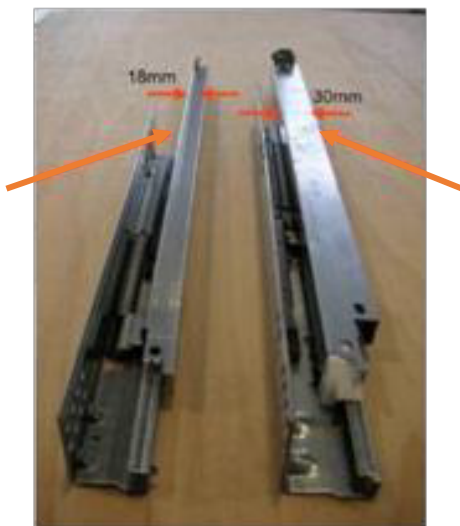



Basic product info

How many **lengths** is **TANDEM** available in?

TANDEM full extension is available in the following lengths:

- **350mm, 400mm, 450mm, 500mm**



TANDEM single extension is available in the following lengths:

- **270mm, 300mm, 350mm, 400mm, 450mm, 500mm, 550mm**



How many **load capacities** are available?

TANDEM runners are available in the following load capacities:-

- **30kg**

Full extension

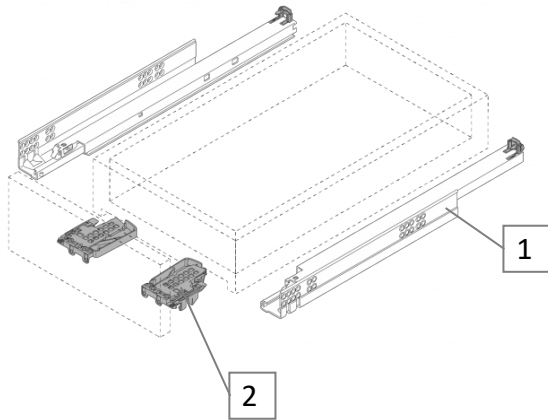

1. Drawer runner (30kg or 50kg)
2. Locking device (2)

Single extension

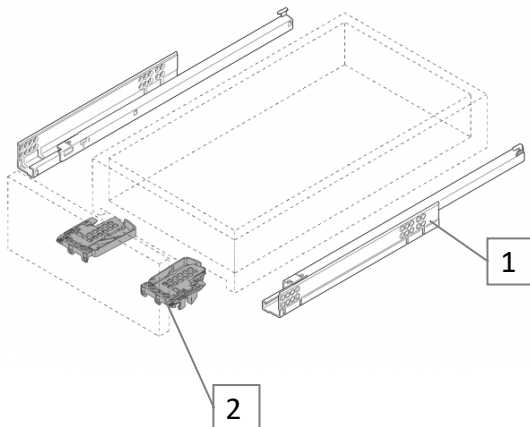

1. Drawer runner (30kg)
2. Locking device (2)



Basic product info

What is the **country of origin**?

TANDEM is made in 1 of our **8 factories in Austria**.

[Right-click here](#) to learn more about our factories in Austria.

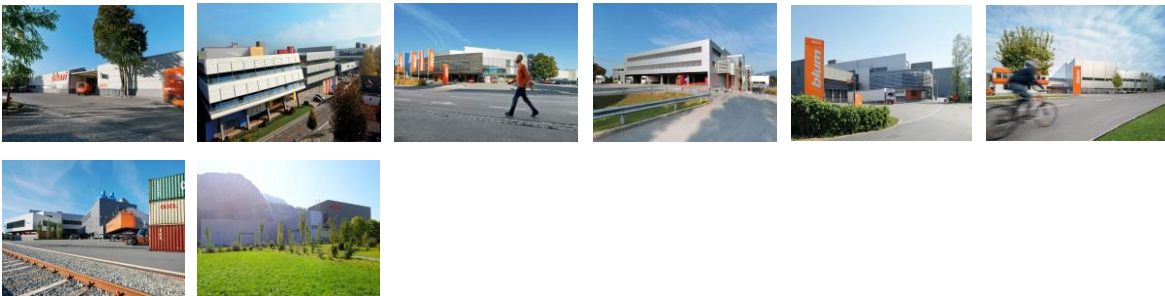

What is the **warranty** for TANDEM?

All Blum mechanical products come with a lifetime warranty.

Please [Right-click here](#) to download our warranty.

How is TANDEM **tested**?

All TANDEM are tested for **100,000 opening and closing cycles**.

[Right-click here](#) to learn more about Blum Quality and how we test our products.

Where can I find **more information about TANDEM**?

1. You can [Right-click here](#) to open the TANDEM page on **blum.com**
2. You can also find many **application images** on **connect.blum.com**.
[Right-click here](#) to see how TANDEM can be applied to various places around your home.



Basic product info

Can I use TANDEM for **handle-less designs**?

Yes! There are 2 options for you to achieve this.

1. The **drawer front can be designed to have a 45-degree finger pull** on the top or bottom part of the drawer.
3. You can also combine the **BLUMOTION** runner with the **SERVO-DRIVE** electrical motion support system.



45-degree finger pull

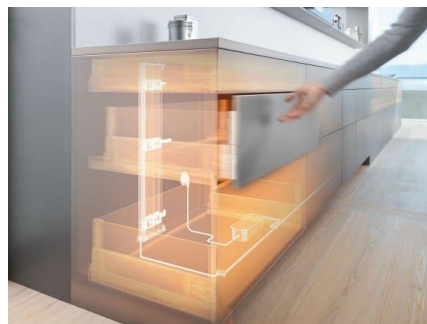

SERVO-DRIVE equipped drawers

What **motion technologies** does TANDEM offer?

TANDEM comes in soft closing **BLUMOTION**, **TIP-ON BLUMOTION** as well as with the electrical motion support system **SERVO-DRIVE**.

- **BLUMOTION** is for **soft closing** solutions – normally when the door is fitted with a handle.
- **SERVO-DRIVE** is for **handle-less** designs. The drawer opens with a light push against the front panel



Can I **open** TANDEM with **TIP-ON**?

No. TANDEM does not have a TIP-ON option.

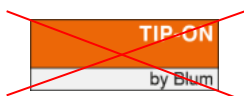



Basic product info

Can I **still open** my SERVO-DRIVE TANDEM if the **power is out**?

Yes! When the power goes out, SERVO-DRIVE for TANDEM is not activated.

However, you can continue to open and close manually without restrictions. Once the power has been restored, you can carry on using everything as normal without having to make any additional adjustments.

How do I **maintain** my **TANDEM**?

Blum products are generally maintenance-free.

However, during assembly and usage of Blum products, it is inevitable that stains or other kinds of contamination will appear on the product or its surfaces.

When cleaning, make sure to treat the protective areas and materials with care. Avoid applying abrasive chemicals as they will cause damage to the product.



For more information on cleaning and general maintenance instructions, please [Right-click here](#) to download our "**Cleaning and maintenance**" manual.

What is the **difference** between **TANDEM** and **MOVENTO**?

Single and Full extension

TANDEM comes in single & full extension.

MOVENTO only comes in full extension.

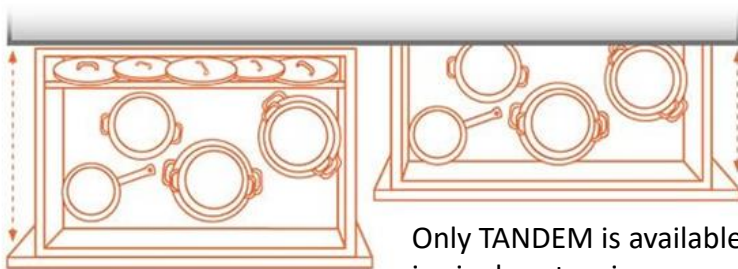

Only **TANDEM** is available in single extension

TANDEM & **MOVENTO** are available in full extension

Load capacity

TANDEM offers a load capacity of 30kg, whereby **MOVENTO** offers 40kg and 70kg



TANDEM & **MOVENTO** perform outstandingly even when fully extended and heavily laden.

Even very wide and heavy pull-outs have a smooth-running action thanks to high dynamic carrying capacities of 30, 40 and 70 kg.



Basic product info

What is the **difference** between **TANDEM** and **MOVENTO**?

MOVENTO has 4 dimensional adjustment options built into the locking device

- Height, tilt, depth and side adjustments



With **MOVENTO**, you can adjust the **height, tilt and depth of the front and modify side gaps**. There is no need to alter the drawer and you get a precise gap layout quickly, easily and without tools.

TANDEM provides only height adjustment in the locking device

- Tilt adjustment is the back of the runner
- Side adjustments requires an additional product to be fitted into the drawer front panel

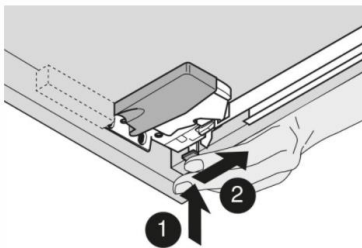

TANDEM offers **height adjustment** in the locking device.

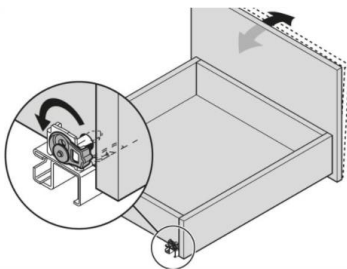

Tilt adjustment for TANDEM can be found at the back of the runner.

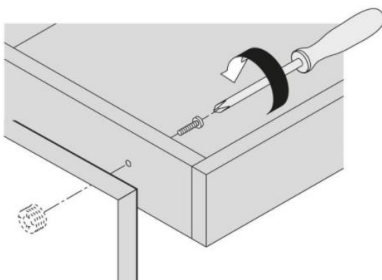

Side adjustment for TANDEM requires an add on product.

Front adjuster			
	Colour	Material	Part no.
	Natural	Nylon	295.1000



Basic product info

Overview of differences between TANDEM and MOVENTO?

TANDEM



30 kg



270 mm



300 mm



350 mm



400 mm



450 mm



500 mm



550 mm



BLUMOTION



SERVO-DRIVE



Height & tilt adjustments



Feather light glide

MOVENTO



40 kg



60 kg



270 mm



300 mm



350 mm



400 mm



450 mm



500 mm



550 mm



600 mm



650 mm



700 mm



750 mm



BLUMOTION



TIP-ON BLUMOTI...



SERVO-DRIVE



Height, tilt, depth and side adjustments



Synchronised feather light glide

What is the **min/max cabinet width** for TANDEM?

The **minimum cabinet width** is 300mm.
The **maximum cabinet width** is 1200mm.

Can I design my cabinet **wider than 1200mm**?

No! TANDEM will not be able to function properly if the cabinet dimension are exceeding the specifications stated by Blum.

Furthermore, **the warranty might be voided** as it is considered as “**not used for the products intended purpose**”

Can I design my cabinet **narrower than 300mm**?

Yes! But you have to use a special construction call **SPACE TWIN** for this.

Can I use a **TIP-ON** mechanism with **TANDEM**?

No! This does not work.

TIP-ON is designed for casement doors and AVENTOS TIP-ON only. **It does not work** with drawer runners!

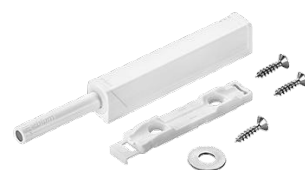

TANDEM

TIP-ON mechanism

What are the **minimum internal carcass dimensions (min depth)**

The **minimum internal carcass depth** is **nominal runner length + 3mm**

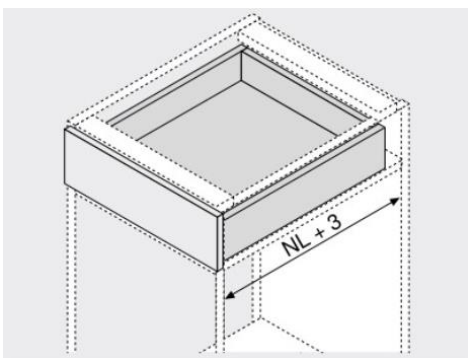

Example: if you are using a **500mm TANDEM runner**, your **cabinet** must have a **minimum of 503mm internal carcass depth**.

How to I install the locking device?

The locking device is installed beneath the drawer.

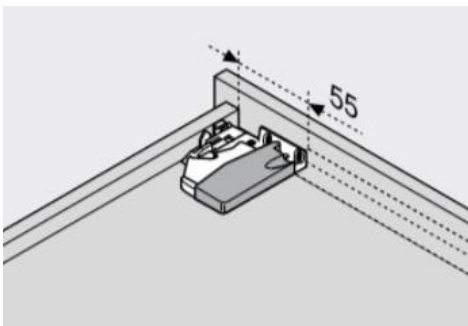

How do I properly position the runner in the cabinet?

The fourth hole of the runner must be at exactly 37mm from the front of the cabinet

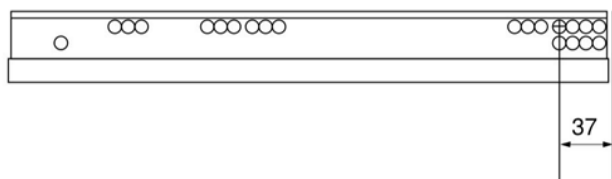

When I choose to use **SERVO-DRIVE** – what extra items do I need?

You need to purchase the following items in addition to the TANDEM BLUMOTION mechanism.

Drive units and a transformer

- The Drive unit triggers the opening signal with a single touch on the front.
- The 24-watt transformer is mounted to the back of the cabinet with a transformer housing



Bracket profile

Flexible attachment of drive units to suit the individual positions of the pull-outs



Distance bumpers & cabling

- Distance bumpers ensure the required trigger path of at least 2 mm.
- Cables can be connected via our flexible piercing technology

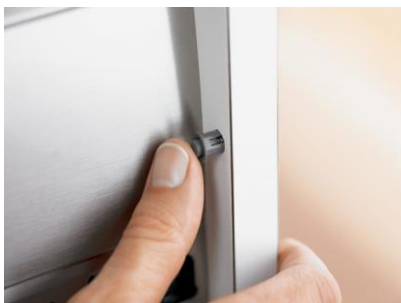

How many drive units do I need?

You need 1 drive unit per drawer.

The drive units are always mounted **behind the drawer** at the back of the cabinet.

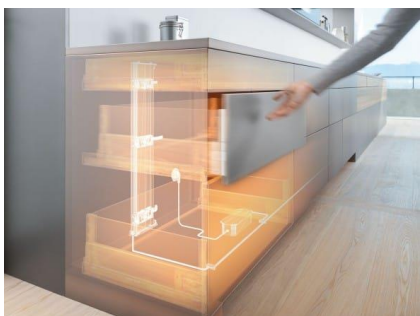

Do I need a SERVO-DRIVE transformer for every cabinet?

No! One Blum SERVO-DRIVE transformer can be shared across up to 50 TANDEM drive units.

Can I use TANDEM runners for TANDEMBOX?

No! TANDEMBOX and TANDEM are **not compatible**. They both use different runner technology!

What do you mean by drawer length?

The **drawer length** (nominal length) refers to the depth of the drawer – not the width!

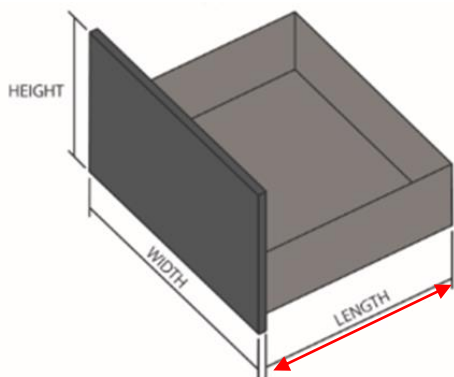

How do I **insert** the drawer into the cabinet?

1. **Pull out both runners (L&R) all the way**
2. Place drawer on **top of the runners**
3. **Push the drawer into the cabinet – all the way** – until you hear a ‘click’.
Now the drawer is connected to the runners, and you can use it as per normal.

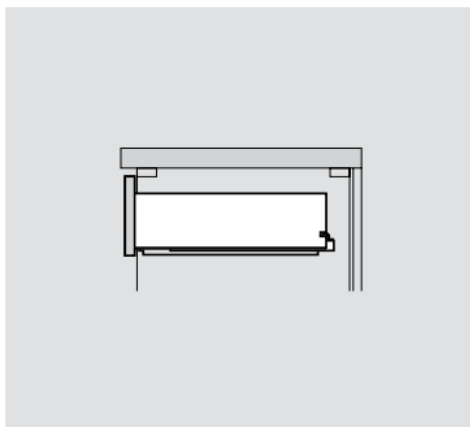
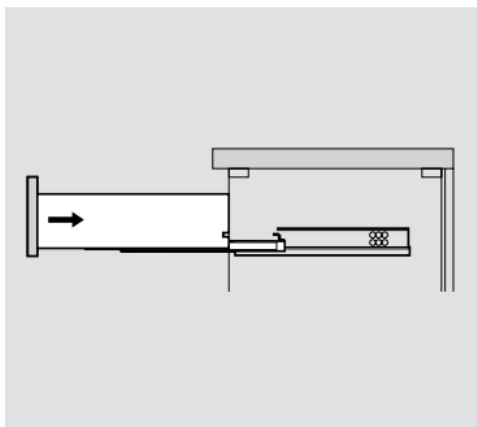

How do I **remove** the drawer from my cabinet?

1. Press the orange clips below the drawer **AND**
2. **THEN** pull the drawer towards you.

<https://youtu.be/JNMrTFAOw7s>

Careful! Once you have detached the drawer from the runners, you will have to carry all the weight of the drawer. Make sure that the drawer is completely empty before removing the drawer!

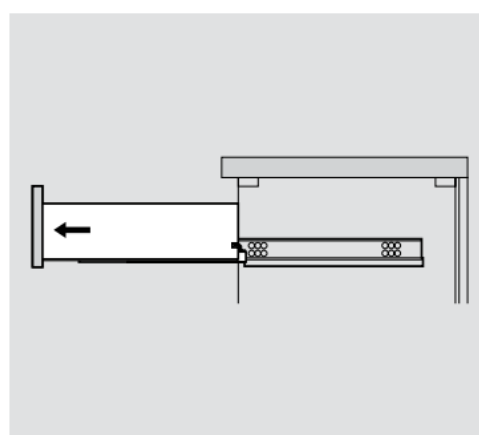
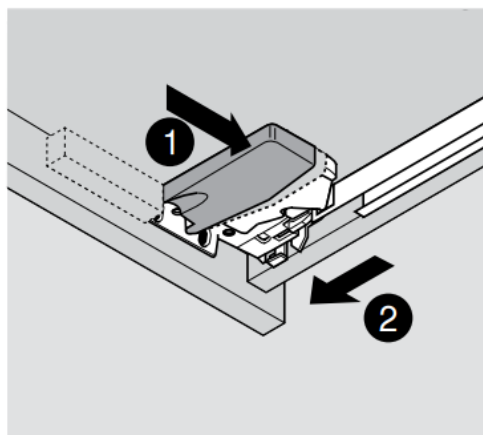



Trouble shooting

My TANDEM drawer does not run smoothly anymore. Why?

This can have multiple reasons:-

1. **The drawer has been overloaded.** Do not load more weight into the drawer than it has been designed for.
2. Your drawer runner **was not protected (covered) during installation.** Saw dust and other dirt from the job site work has clogged up the mechanism and causes it to fail.

Please Note: Neither of the above-mentioned problems are covered via the warranty!

Can I exchange the product after Installation?

No. Once the product was installed, it is no longer eligible to be returned, exchanged or refunded.

There is a **clicking sound** when I close my TANDEM drawer

The most common reason is that the back panel of the drawer has not been cut-to-size properly. See proper cutting dimensions above.

I can hear a **squeaking sound** when I close my drawer

The most common reason is that the **drawer runners were unprotected during installation.**

Saw dust and other dirt from the job site work has clogged up the mechanism and causes it to make this noise.

My TANDEM drawer is shaky and can't close properly. Why?

This could be due to the following reason:-

The construction of your drawer might be incorrect.

- Please check if your drawer side panels are longer on the side of the drawer. This construction restricts the left/right movements of the drawer box during opening and closing.

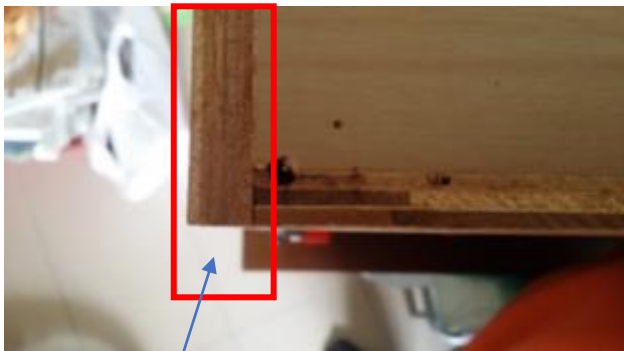

Wrong construction
The drawer side is too short



Correct construction
The drawer side is longer and provides movement restriction to the runner below